

Cottage



SANATOGA RIDGE  
COMMUNITY

# HIGHLAND II

## 2 Bedroom, 1 Bathroom

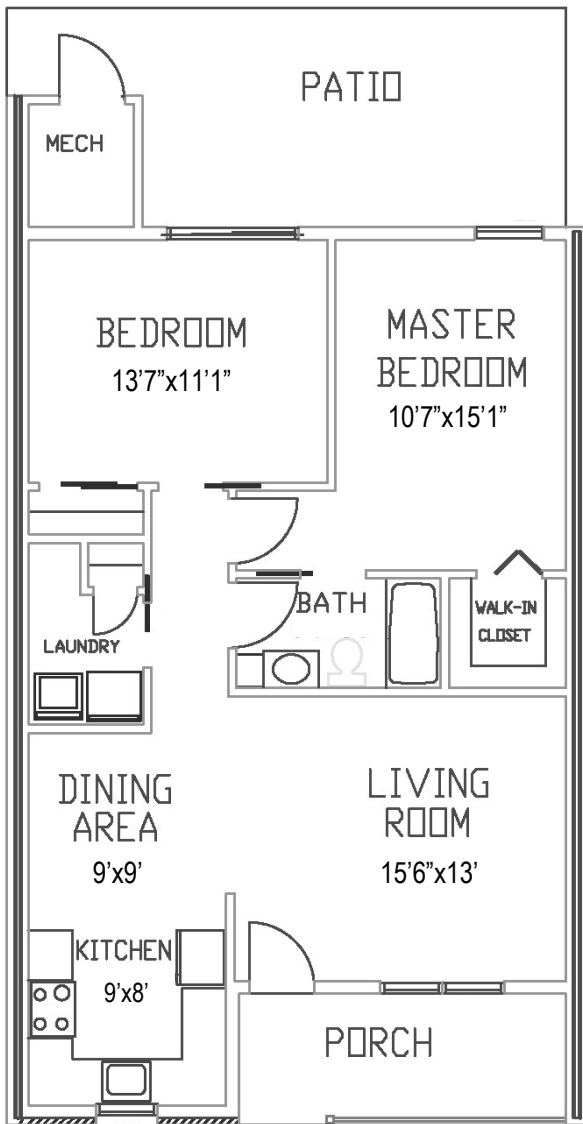

Floor plans shown are not to scale  
and indicate approximate square footage

*(Living Space 870 SF, Garage 230 SF)*

### Appliances Included:

Refrigerator, Stove, Microwave, Dishwasher,  
Garbage Disposal, Washer, Dryer

### Updated Options:

Flooring, Carpeting, Lighting, Hardware,  
Countertop, Backsplash

### Entry Fee:

*75% Refund at Resale*

## Starting at \$186,700

Upgraded features on reverse side

### Monthly

## Maintenance & Service Fee includes:

- 24/7 On-Call Maintenance
- Property and School Taxes
- Property Insurance
- Maintenance  
(Inside, Outside, and Appliances)
- Water/Sewer
- Trash/Recycling
- Landscaping
- Snow Removal

*1 Resident: \$960*

*2 Residents: \$1154*

*Fee ends when home is returned for resale.*

- Homes have forced air/natural gas heat and central air.
- Resident is responsible for utilities (heat, electric, cable, internet, & phone).
- Resident is encouraged to carry content insurance for possessions; i.e.: tv, furniture, jewelry, etc.

\*05-16-2022

2461 E. High St., Pottstown, PA 19464 | Phone: 610.326.6282 | Fax: 610.326.3142

SanatogaRidge.com | Find us on YouTube



### Upgraded Features: Highland II

|                                 |          |
|---------------------------------|----------|
| Garage                          | \$22,000 |
| Extra half bath                 | \$ 3,300 |
| Patio Enclosure                 | \$ 5,200 |
| Patio Enclosure with Heat & Air | \$ 7,800 |
| 4-Season Sunroom Addition       | \$20,000 |
| Extra patio                     | \$ 2,000 |
| Single home                     | \$13,000 |

Upgraded features vary by home

## NOTES